

*Light  
of your  
home*

*Revolutionary  
tubus  
Skylight*

*Patented  
system  
of lighting*

IG PASSIVHAUS  
Informations-Gemeinschaft Passivhaus Deutschland



[www.abcweb.cz](http://www.abcweb.cz)

## Uniquenesses of system



### Fresnel lenses

Typical Fresnel lenses situated in a diffuser are responsible for a smooth diffusion of sun beams into room (every lens under 45° angle). It brings smoother diffusion of lighting.

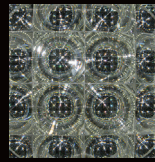

### Night lighting

It is possible to install low-cost and efficient LED diodes into Sunizer quite easily.



### Round and square shape (frame)

First skylight in the world. Which offers two types of diffuser: Standard round shape and also square shape suitable for special type of ceilings.



### Simple installation in flat roof

Installation in flat roof is very simple because of a unique flashing plate.



### Roofs openings square shape

Offer an easy installation into pitched roof, the shape is hardly recognizable from a dormer. Final component can be made off a flat glass with a filter or a polycarbonate top dome which eliminates sunbeams reflection outside the system.

### Wide range of accessories

The most popular accessories are LED diodes, shadow damper (for bedrooms), remote controlled LED diodes or damper, color variety of diffuser trim (gold, silver and so on), heat insulation glass and diffuser useful as spare electronic lighting.

## Recommended diameter of piping according size of room

| Type (diameter) | Area lit (to a normal daylight level) |
|-----------------|---------------------------------------|
| Sunizer 230 mm  | od 1 – 7 m <sup>2</sup>               |
| Sunizer 330 mm  | od 5 – 17 m <sup>2</sup>              |
| Sunizer 430 mm  | od 9 – 27 m <sup>2</sup>              |
| Sunizer 530 mm  | od 16 – 47 m <sup>2</sup>             |

Pipe diameter of Sunizer relates to the size of a room. Every type of Sunizer has specific size of circle which let the sufficient amount of light get into a room.

**Calculation lighting is available on request.**

## Variety of installation

It is possible to install **Sunizer** in many different ways for example: lean out, bend and extend to any demanded length. Installation into different types of roof tiles and different types of ceiling is just a natural examples of its wide range of flexibility.

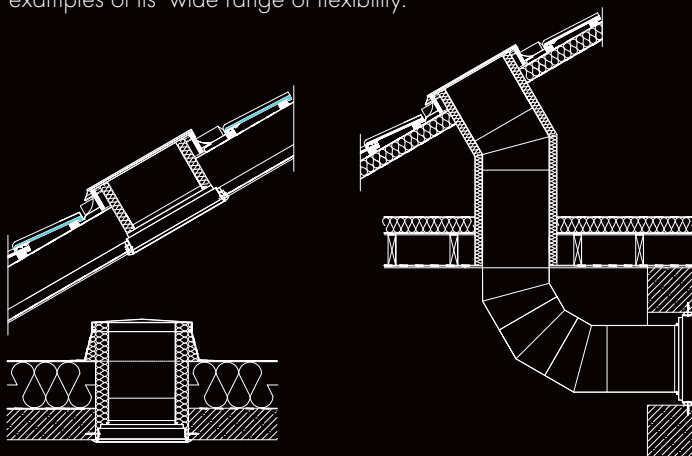

### Sample of Tubus Skylight Sunizer Ø530mm

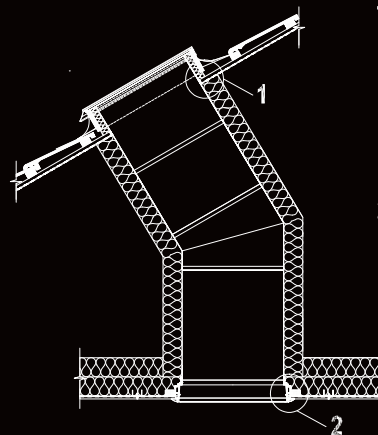

1 - Detail of Hydroinsulation Juta



2 - Detail of diffuser installed in ceiling



**SUNIZER™**  
WWW.SUNIZER.CZ

WWW.JUTA.CZ  
**JUTA**

**ABC**

**AMERICAN BOHEMIAN CORPORATION**  
S.R.O.

Made in EU:

Ledárenská 57, Brno – Holásky 620 00  
Tel.: +420 545 234 444, +420 545 234 443  
E-mail: info@abcweb.cz  
www.abcweb.cz